



# Richards Residential Supplies

FREEPHONE: 0800 0743749 TELEPHONE: 01282 861921 Fax: (01282) 865449

[richard@richardsresidential.co.uk](mailto:richard@richardsresidential.co.uk) [april@richardsresidential.co.uk](mailto:april@richardsresidential.co.uk)

## Are you planning an Extension? New Build? or Refurbishment?



### If you are - we can help...

We work closely with our clients with an existing building, or work alongside the architect assisting the spatial planning to ensure optimum layouts for each of the rooms. We use our experience and CAD software to develop tailor-made room layouts and elevations.

This really does help our customers to visualise how their space can look with furniture and soft furnishings in place and to scale. We use photo images of the actual fabrics and carpets incorporated in the design, this really does give a realistic impression, enabling many quick and confident decisions.

We have hundreds of fantastic new designs of *Inherently Flame Retardant* fabrics to choose from, along with high performance upholstery fabrics and faux leathers. These are some of our fabric suppliers, why not take a look at their websites for inspiration and ideas:

[www.panaz.co.uk](http://www.panaz.co.uk) [www.edmundbell.com](http://www.edmundbell.com)

[www.skoposdesignltd.com](http://www.skoposdesignltd.com) [www.ashforrdcontract.com](http://www.ashforrdcontract.com)

## Did You Know?

As part of our personal service, we offer a complete turnkey package including spatial planning, interior design, and project management, so, whether you want to purchase a single chair, or, to fully furnish and equip a new build, we are a one stop shop helping you with your decision and saving you valuable time and money.

We also manufacture all our soft furnishings in our own workrooms giving the added benefit of everything made to our customers own specifications.

So, only dealing with one company for all your requirements takes out the stress, saves time and gives you peace of mind.



## Fresh Start - New Décor?

Why not ring Richard or April to discuss your requirements?

We can make a big impression for less money than you think, you might just be surprised at the price!



## *This is an example of a multi-functional Cinema, Boardroom and Training Centre*



This room needed to serve multi-purposes, a hi-tech cinema and a boardroom/training centre, both to seat 12 people comfortably.

The brief was that the room needed to be practical and functional, and can quickly be changed from one function to the other, whilst maintaining a tidy appearance with no chairs stacked up, or tables leaning against the walls.

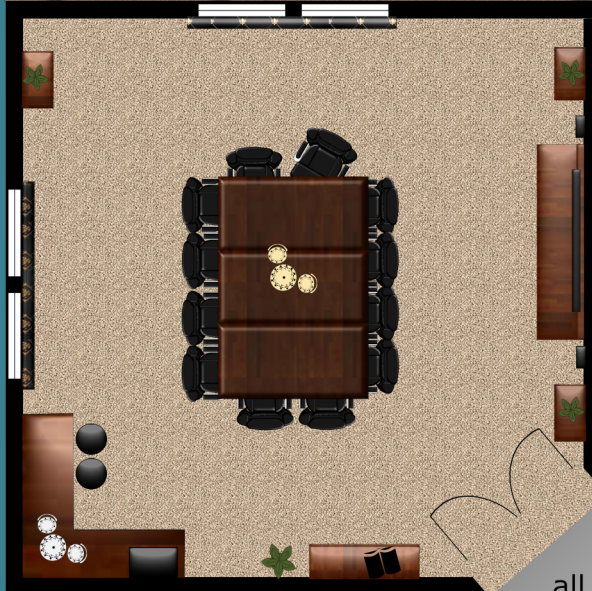

Above is the floor plan of the boardroom layout showing all 3 tables in the Centre of the room. The 60" TV doubles up as a interactive whiteboard to maximize usage for all functions.

Above is a elevation of the wall that incorporates a 'L' shape unit that was specially designed for the space. The left hand side includes double cupboards and drawers with worktop space to hold a coffee machine etc. The right hand side has a hidden compartment for the 3 boardroom tables to slide into, and extra worktop space along with handy bar stools.



On the right all the tables are neatly tucked away now in the 'L' shaped unit and the chairs have been arranged for the cinema viewing.

To the right is the focal point of the room with the 60" TV. This sits nicely against the wall in a custom built unit designed to conceal all the wiring and plugholes, and also giving storage for the cinema equipment and DVDs etc. Another benefit of this room and TV is to use a games consol giving vital fun and exercise for the residents and relatives.

